



**D.KENNEDY
STEEL SUPPLIES LTD**



STOCK RANGE & SPECIFICATIONS

Call Us: +353 1 6260399

Email: sales@dkennedysteel.ie

Web: www.dkennedysteel.ie



ABOUT US

Company Profile

Servicing the Steel industry since 1983 & conveniently based in Palmerstown. (Just off the M50) Dublin 20. D. Kennedy Steel can cater for all your steel needs. We are an Irish-owned, family-run business, your business is our business & we do our utmost to maintain our customer satisfaction rating. As one of Ireland's leading steel stockholders D. Kennedy Steel Supplies provides an excellent service to customers through a high-quality, extensive range of products and expert advice, drawing on our experience and technical expertise in the steel industry in Ireland.

Established in 1983, D. Kennedy Steel supplies an extensive range of the highest quality steel products including steel bars, steel sections, sheet steel, steel plates, weld mesh, universal beams and steel columns.

We also offer same-day or next-day delivery to the local area and a steel-cutting service. We offer a wide range of products and services at very competitive prices. No order is too large or small. We pride ourselves on our level of service and friendly staff.





Products & Services

Our steel range is one of the largest in Ireland and our impressive stock range includes steel Beams, steel Channels, steel Flats, steel Angles, steel Rounds, steel Squares, steel Tube, steel boxes, Galvanised tubes, Sheet/plate and steel Mesh.

D. Kennedy Steel has the flexibility to cater to your bespoke requirements. Whether it be standard stock bars, cut to size, shotblasted and primer painted material or a combination of all of them D. Kennedy Steel have an extensive range of saws and facilities to meet your precise needs. With ongoing progressive investment, in addition to the facilities at our Dublin Site, we can now offer fast delivery service for the local area.



Table of Contents

BEAMS	1
PFC	9
EQUAL ANGLE	10
UNEQUAL ANGLE	13
FLAT	15
ROUND	23
SQUARE	25
SHEET.....	26
PLATE	31
CHEQUER PLATE	34
HOLLOW.....	36
GALV TUBE.....	50
MESH	52
OPEN STEEL FLOORING	54
GALVE COIL.....	57
Q CLAMP	58



**D.KENNEDY
STEEL SUPPLIES LTD**



BEAMS

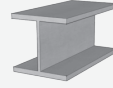

PRODUCT CODE	DESCRIPTION	DENSITY
HEA/HEB		
HEA100	EURO WF BEAM 96 X 100 X 16.7kg	16.70
HEA700	EURO WF BEAM 690 X 300 X 204kg	204.00
HEB100	EURO WF BEAM 100 X 100 X 20.4kg	20.40
HEB140	EURO WF BEAM 140 X 140 X 33.7kg	33.70
HEB160	EURO WF BEAM 160 X 160 X 42.6kg	42.60
HEB300	EURO WF BEAM 300 X 300 X 117kg	117.00
HEB400	EURO WF BEAM 400 X 400 X 155kg	155.00



**D.KENNEDY
STEEL SUPPLIES LTD**



IPE

BEAMS

PRODUCT CODE	DESCRIPTION	DENSITY
IPE100	EURO I BEAM 100 X 55 X 8.1kg	8.10
IPE120	EURO I BEAM 120 X 65 X 10.4 kg	10.40
IPE140	EURO I BEAM 140 X 73 X 12.9kg	12.90
IPE160	EURO I BEAM 160 X 82 X 15.8kg	15.80
IPE180	EURO I BEAM 180 X 91 X 18.8kg	18.80
IPE200	EURO I BEAM 200 X 100 X 22.4kg	22.40
IPE220	EURO I BEAM 220 X 110 X 26.2kg	26.20
IPE240	EURO I BEAM 240 X 120 X 30.7 kg	30.70
IPE270	EURO I BEAM 270 X 135 X 36.1 kg	36.10
IPE300	EURO I BEAM 300 X 150 X 42.4 kg	42.20



**D.KENNEDY
STEEL SUPPLIES LTD**



UB'S

BEAMS

PRODUCT CODE	DESCRIPTION	DENSITY
UB1277613	UB 127 X 76 X 13kg	13.00
UB1528916	UB 152 X 89 X 16 kg	16.00
UB17810219	UB 178 X 102 X 19 kg	19.00
UB20310223	UB 203 X 102 X 23 kg	23.10
UB20313325	UB 203 X 133 X 25 kg	25.10
UB20313330	UB 203 X 133 X 30 kg	30.00
UB25410222	UB 254 X 102 X 22 kg	22.00
UB25410225	UB 254 X 102 X 25 kg	25.20
UB25410228	UB 254 X 102 X 28 kg	28.30
UB25414631	UB 254 X 146 X 31 kg	31.10
UB25414637	UB 254 X 146 X 37 kg	37.00
UB25414643	UB 254 X 146 X 43 kg	43.00
UB30510225	UB 305 X 102 X 25 kg	24.80
UB30510228	UB 305 X 102 X 28 kg	28.20
UB30510233	UB 305 X 102 X 33 kg	33.00
UB30512737	UB 305 X 127 X 37 kg	37.00
UB30512742	UB 305 X 127 X 42 kg	41.90
UB30512748	UB 305 X 127 X 48 kg	48.10
UB30516540	UB 305 X 165 X 40 kg	40.30



**D.KENNEDY
STEEL SUPPLIES LTD**



UB'S

BEAMS

PRODUCT CODE	DESCRIPTION	DENSITY
UB30516546	UB 305 X 165 X 46 kg	46.10
UB30516554	UB 305 X 165 X 54 kg	54.00
UB35612733	UB 356 X 127 X 33 kg	33.00
UB35612739	UB 356 X 127 X 39 kg	39.00
UB35617145	UB 356 X 171 X 45 kg	45.00
UB35617151	UB 356 X 171 X 51 kg	51.00
UB35617157	UB 356 X 171 X 57 kg	57.00
UB35617167	UB 356 X 171 X 67.1 kg	67.10
UB356368129	UB 356 X 368 X 129 kg	129.00
UB356368177	UB 356 X 368 X 177 kg	177.00
UB356406235	UB 356 X 406 X 235 kg	235.00
UB40614039	UB 406 X 140 X 39 kg	39.00
UB40614046	UB 406 X 140 X 46 kg	46.00
UB40617854	UB 406 X 178 X 54 kg	54.10
UB40617860	UB 406 X 178 X 60 kg	60.01
UB40617867	UB 406 X 178 X 67 kg	67.10
UB40617874	UB 406 X 178 X 74 kg	74.20
UB45715252	UB 457 X 152 X 52.3 kg	52.30
UB45715260	UB 457 X 152 X 59.8 kg	59.80



**D.KENNEDY
STEEL SUPPLIES LTD**



UB'S

BEAMS

PRODUCT CODE	DESCRIPTION	DENSITY
UB45715267	UB 457 X 152 X 67.2 kg	67.20
UB45715274	UB 457 X 152 X 74.2 kg	74.20
UB45719167	UB 457 X 191 X 67 kg	67.00
UB45719174	UB 457 X 191 X 74 kg	74.30
UB45719182	UB 457 X 191 X 82 kg	82.00
UB45719189	UB 457 X 191 X 89.3 kg	89.30
UB45719198	UB 457 X 191 X 98.3 kg	98.30
UB533210101	UB 533 X 210 X 101 kg	101.00
UB533210109	UB 533 X 210 X 109 kg	109.00
UB533210122	UB 533 X 210 X 122 kg	122.00
UB53321082	UB 533 X 210 X 82 kg	82.00
UB53321092	UB 533 X 210 X 92.1 kg	92.10
UB610229101	UB 610 X 229 X 101.2 kg	101.20
UB610229113	UB 610 X 229 X 113 kg	113.00
UB610229125	UB 610 X 229 X 125.1 kg	125.10
UB610229140	UB 610 X 229 X 140 kg	140.00
UB61030514	UB 610 X 305 X 149.1 kg	149.10
UB610305179	UB 610 X 305 X 179 kg	179.00
UB610305238	UB 610 X 305 X 238 kg	238.10



**D.KENNEDY
STEEL SUPPLIES LTD**



UB'S

BEAMS

PRODUCT CODE	DESCRIPTION	DENSITY
UB762267147	UB 762 X 267 X 147 kg	146.90
UB762267197	UB 762 X 267 X 197 kg	196.80
UB838292194	UB 838 X 292 X 194 kg	194.00
UB914305201	UB 914 X 305 X 201 kg	201.00
UB914305224	UB 914 X 305 X 224 kg	224.00
UB914305253	UB 914 X 305 X 253 kg	253.00
UB914305289	UB 914 X 305 X 289 kg	289.10
UB914419388	UB 914 X 419 X 388 kg	388.00
UB1016305222	UB 1016 X 305 X 222 kg	222.00
UB1016305272	UB 1016 X 305 X 272 kg	272.00
UB1016305314	UB 1016 X 305 X 314 kg	314.00
UB1016305393	UB 1016 X 305 X 393 kg	393.00
UB1016305438	UB 1016 X 305 X 438 kg	438.00
UB1016305487	UB 1016 X 305 X 487 kg	487.00



**D.KENNEDY
STEEL SUPPLIES LTD**



UC'S

BEAMS

PRODUCT CODE	DESCRIPTION	DENSITY
UC15223	UC 152 X 152 X 23 kgs/pm	23.00
UC15230	UC 152 X 152 X 30 kgs/pm	30.00
UC15237	UC 152 X 152 X 37 kgs/pm	37.00
UC20346	UC 203 X 203 X 46 kgs/pm	46.10
UC20352	UC 203 X 203 X 52 kgs/pm	52.00
UC20360	UC 203 X 203 X 60 kgs/pm	60.00
UC20371	UC 203 X 203 X 71 kgs/pm	71.00
UC20386	UC 203 X 203 X 86 kgs/pm	86.10
UC25473	UC 254 X 254 X 73 kgs/pm	73.10
UC25489	UC 254 X 254 X 89 Kgs/pm	88.90
UC254107	UC 254 X 254 X 107 kgs/pm	107.10
UC254132	UC 254 X 254 X 132 kgs/pm	132.00
UC254167	UC 254 X 254 X 167 kgs/pm	167.10
UC30597	UC 305 X 305 X 97 kgs/pm	96.90
UC305118	UC 305 X 305 X 118 KGS/PM	117.90
UC305137	UC 305 X 305 X 137 KGS/PM	136.90
UC305158	UC 305 X 305 X 158 kgs/pm	158.10
UC305198	UC 305 X 305 X 198 kgs/pm	198.10
UC305240	UC 305 X 305 X 240 kgs/pm	240.00



**D.KENNEDY
STEEL SUPPLIES LTD**



 **UC'S**

BEAMS

PRODUCT CODE	DESCRIPTION	DENSITY
UC305283	UC 305 X 305 X 283 kgs/pm	282.90
UC356368129	UC 356 X 368 X 129 kgs/pm	129.00
UC356406340	UC 356 X 406 X 340 kgs/pm	340.00
UC356406393	UC 356 X 406 X 393 kgs/pm	393.00



PFC



PRODUCT CODE	DESCRIPTION	DENSITY
PFC5025	PFC 50 X 25mm	3.86
PFC5038	PFC 50 X 38mm	5.80
PFC7638	PFC 76 X 38mm	6.70
PFC10050	PFC 100 X 50mm	10.20
PFC12565	PFC 125 X 65mm	14.80
PFC15075	PFC 150 X 75mm	17.90
PFC15090	PFC 150 X 90mm	23.90
PFC18075	PFC 180 X 75mm	20.30
PFC18090	PFC 180 X 90mm	26.10
PFC20075	PFC 200 X 75mm	23.40
PFC20090	PFC 200 X 90mm	29.70
PFC23075	PFC 230 X 75mm	25.70
PFC23090	PFC 230 X 90mm	32.20
PFC230908	PFC 230 X 90mm	32.20
PFC26075	PFC 260 X 75mm	27.60
PFC26090	PFC 260 X 90mm	34.80
PFC300100	PFC 300 X 100mm	45.50
PFC30090	PFC 300 X 90mm	41.00
PFC380100	PFC 380 X 100mm	54.00
PFC430100	PFC 430 X 100mm	64.00



EQUAL ANGLE

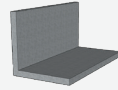

PRODUCT CODE	DESCRIPTION	DENSITY
A20203	ANGLE 20 X 20 X 3mm	0.88
A25253	ANGLE 25 X 25 X 3mm	1.12
A25255	ANGLE 25 X 25 X 5mm	1.78
A30303	ANGLE 30 X 30 X 3mm	1.36
A30305	ANGLE 30 X 30 X 5mm	2.18
A40403	ANGLE 40 X 40 X 3mm	1.84
A40405	ANGLE 40 X 40 X 5mm	2.97
A40406	ANGLE 40 X 40 X 6mm	3.52
A50503	ANGLE 50 X 50 X 3mm	2.33
A50505	ANGLE 50 X 50 X 5mm	3.77
A50506	ANGLE 50 X 50 X 6mm	4.47
A50508	ANGLE 50 X 50 X 8mm	5.82
A60606	ANGLE 60 X 60 X 6mm	5.42
A60608	ANGLE 60 X 60 X 8mm	7.09
A70706	ANGLE 70 X 70 X 6mm	6.38
A70708	ANGLE 70 X 70 X 8mm	8.36
A80806	ANGLE 80 X 80 X 6mm	7.34



EQUAL ANGLE

PRODUCT CODE	DESCRIPTION	DENSITY
A80808	ANGLE 80 X 80 X 8mm	9.63
A808010	ANGLE 80 X 80 X 10mm	11.90
A90906	ANGLE 90 X 90 X 6mm	8.30
A90908	ANGLE 90 X 90 X 8mm	10.90
A909010	ANGLE 90 X 90 X 10mm	13.40
A909012	ANGLE 90 X 90 X 12mm	15.90
A1001006	ANGLE 100 X 100 X 6mm	9.32
A1001008	ANGLE 100 X 100 X 8mm	12.20
A10010010	ANGLE 100 X 100 X 10mm	15.00
A10010012	ANGLE 100 X 100 X 12mm	17.80
A1201208	ANGLE 120 X 120 X 8mm	14.70
A12012010	ANGLE 120 X 120 X 10mm	18.20
A12012012	ANGLE 120 X 120 X 12mm	21.60
A12012015	ANGLE 120 X 120 X 15mm	26.60
A15015010	ANGLE 150 X 150 X 10mm	23.00
A15015012	ANGLE 150 X 150 X 12mm	27.30
A15015015	ANGLE 150 X 150 X 15mm	33.80
A15015018	ANGLE 150 X 150 X 18mm	40.10
A18018018	ANGLE 180 X 180 X 18mm	48.60



**D.KENNEDY
STEEL SUPPLIES LTD**



EQUAL ANGLE

PRODUCT CODE	DESCRIPTION	DENSITY
A20020012	ANGLE 200 X 200 X 12mm	36.74
A20020016	ANGLE 200 X 200 X 16mm	48.50
A20020018	ANGLE 200 X 200 X 18mm	54.20
A20020020	ANGLE 200 X 200 X 20mm	59.90



UNEQUAL ANGLE

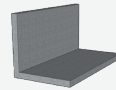

PRODUCT CODE	DESCRIPTION	DENSITY
A65506	ANGLE 65 X 50 X 6mm	5.16
A75506	ANGLE 75 X 50 X 6mm	5.65
A75508	ANGLE 75 X 50 X 8mm	7.39
A80607	ANGLE 80 X 60 X 7mm	7.36
A100506	ANGLE 100 X 50 X 6mm	6.85
A100508	ANGLE 100 X 50 X 8mm	9.00
A100657	ANGLE 100 X 65 X 7mm	8.77
A100658	ANGLE 100 X 65 X 8mm	9.94
A1007510	ANGLE 100 X 75 X 10mm	13.00
A1007512	ANGLE 100 X 75 X 12mm	15.40
A100758	ANGLE 100 X 75 X 8mm	10.60
A1257510	ANGLE 125 X 75 X 10mm	15.00
A125758	ANGLE 125 X 75 X 8mm	12.20
A1507510	ANGLE 150 X 75 X 10mm	17.00
A1507512	ANGLE 150 X 75 X 12mm	20.20
A1509010	ANGLE 150 X 90 X 10mm	18.20
A1509012	ANGLE 150 X 90 X 12mm	21.60



UNEQUAL ANGLE

PRODUCT CODE	DESCRIPTION	DENSITY
A1509015	ANGLE 150 X 90 X 15mm	26.60
A20010010	ANGLE 200 X 100 X 10mm	23.00
A20010012	ANGLE 200 X 100 X 12mm	27.30
A20010015	ANGLE 200 X 100 X 15mm	33.70
A20015012	ANGLE 200 X 150 X 12mm	32.00
A20015015	ANGLE 200 X 150 X 15mm	39.60
A20015018	ANGLE 200 X 150 X 18mm	47.10



FLAT

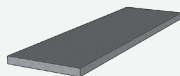

PRODUCT CODE	DESCRIPTION	DENSITY
FL133	FLAT BAR 13 X 3mm	0.33
FL135	FLAT BAR 13 X 5mm	0.51
FL163	FLAT BAR 16 X 3mm	0.39
FL165	FLAT BAR 16 X 5mm	0.63
FL203	FLAT BAR 20 X 3mm	0.49
FL205	FLAT BAR 20 X 5mm	0.79
FL2010	FLAT BAR 20 X 10mm	1.57
FL253	FLAT BAR 25 X 3mm	0.63
FL255	FLAT BAR 25 X 5mm	0.98
FL256	FLAT BAR 25 X 6mm	1.18
FL258	FLAT BAR 25 X 8mm	1.57
FL2510	FLAT BAR 25 X 10mm	1.96
FL2512	FLAT BAR 25 X 12mm	2.36
FL303	FLAT BAR 30 X 3mm	0.75
FL305	FLAT BAR 30 X 5mm	1.18
FL306	FLAT BAR 30 X 6mm	1.41
FL308	FLAT BAR 30 X 8mm	1.88



FLAT

PRODUCT CODE	DESCRIPTION	DENSITY
FL3010	FLAT BAR 30 X 10mm	2.36
FL3012	FLAT BAR 30 X 12mm	2.83
FL403	FLAT BAR 40 X 3mm	0.95
FL405	FLAT BAR 40 X 5mm	1.57
FL406	FLAT BAR 40 X 6mm	1.88
FL408	FLAT BAR 40 X 8mm	2.51
FL4010	FLAT BAR 40 X 10mm	3.14
FL4012	FLAT BAR 40 X 12mm	3.77
FL4015	FLAT BAR 40 X15mm	4.71
FL503	FLAT BAR 50 X 3mm	1.25
FL505	FLAT BAR 50 X 5mm	1.96
FL506	FLAT BAR 50 X 6mm	2.36
FL508	FLAT BAR 50 X 8mm	3.14
FL5010	FLAT BAR 50 X 10mm	3.93
FL5012	FLAT BAR 50 X 12mm	4.72
FL5015	FLAT BAR 50 X 15mm	5.89
FL5020	FLAT BAR 50 X 20mm	7.85
FL5025	FLAT BAR 50 X 25mm	9.81
FL5030	FLAT BAR 50 X 30mm	11.78
FL605	FLAT BAR 60 X 5mm	2.36



FLAT

PRODUCT CODE	DESCRIPTION	DENSITY
FL606	FLAT BAR 60 X 6mm	2.83
FL608	FLAT BAR 60 X 8mm	3.77
FL6010	FLAT BAR 60 X 10mm	4.71
FL6012	FLAT BAR 60 X 12mm	5.65
FL6015	FLAT BAR 60 X 15mm	7.07
FL6020	FLAT BAR 60 X 20mm	9.42
FL658	FLAT BAR 65 X 8mm	4.08
FL6510	FLAT BAR 65 X 10mm	5.11
FL6512	FLAT BAR 65 X 12mm	6.12
FL6515	FLAT BAR 65 X 15mm	7.65
FL6520	FLAT BAR 65 X 20mm	10.21
FL708	FLAT BAR 70 X 8mm	4.39
FL7010	FLAT BAR 70 X 10mm	5.49
FL7012	FLAT BAR 70 X 12mm	6.59
FL7015	FLAT BAR 70 X 15mm	8.24
FL7020	FLAT BAR 70 X 20mm	10.99
FL753	FLAT BAR 75 X 3mm	1.77
FL756	FLAT BAR 75 X 6mm	3.55
FL758	FLAT BAR 75 X 8mm	4.71
FL7510	FLAT BAR 75 X 10mm	5.89



**D.KENNEDY
STEEL SUPPLIES LTD**



FLAT

PRODUCT CODE	DESCRIPTION	DENSITY
FL7512	FLAT BAR 75 X 12mm	7.05
FL7515	FLAT BAR 75 X 15mm	8.85
FL7520	FLAT BAR 75 X 20mm	11.81
FL7525	FLAT BAR 75 X 25mm	14.71
FL806	FLAT BAR 80 X 6mm	3.77
FL808	FLAT BAR 80 X 8mm	5.02
FL8010	FLAT BAR 80 X 10mm	6.28
FL8012	FLAT BAR 80 X 12mm	7.54
FL8015	FLAT BAR 80 X 15mm	9.6
FL8020	FLAT BAR 80 X 20mm	12.56
FL8030	FLAT BAR 80 X 30mm	18.84
FL8040	FLAT BAR 80 X 40mm	25.12
FL908	FLAT BAR 90 X 8mm	5.65
FL9010	FLAT BAR 90 X 10mm	7.07
FL9012	FLAT BAR 90 X 12mm	8.48
FL9020	FLAT BAR 90 X 20mm	14.13
FL1003	FLAT BAR 100 X 3mm	2.36
FL1006	FLAT BAR 100 X 6mm	4.71
FL1008	FLAT BAR 100 X 8mm	6.28
FL10010	FLAT BAR 100 X 10mm	7.85



FLAT

PRODUCT CODE	DESCRIPTION	DENSITY
FL10012	FLAT BAR 100 X 12mm	9.42
FL10015	FLAT BAR 100 X 15mm	11.78
FL10020	FLAT BAR 100 X 20mm	15.72
FL10025	FLAT BAR 100 X 25mm	19.63
FL10050	FLAT BAR 100 X 50mm	39.25
FL11010	FLAT BAR 110 X 10mm	8.64
FL1206	FLAT BAR 120 X 6mm	5.66
FL12010	FLAT BAR 120 X 10mm	9.42
FL12012	FLAT BAR 120 X 12mm	11.31
FL12015	FLAT BAR 120 X 15mm	14.09
FL12020	FLAT BAR 120 X 20mm	18.84
FL1306	FLAT BAR 130 X 6mm	6.13
FL13010	FLAT BAR 130 X 10mm	10.21
FL13012	FLAT BAR 130 X 12mm	12.25
FL13015	FLAT BAR 130 X 15mm	15.31
FL13020	FLAT BAR 130 X 20mm	20.41
FL1408	FLAT BAR 140 X 8mm	8.79
FL14010	FLAT BAR 140 X 10mm	10.99
FL14012	FLAT BAR 140 X 12mm	13.25
FL1506	FLAT BAR 150 X 6mm	7.09



**D.KENNEDY
STEEL SUPPLIES LTD**



FLAT

PRODUCT CODE	DESCRIPTION	DENSITY
FL1508	FLAT BAR 150 X 8mm	9.42
FL15010	FLAT BAR 150 X 10mm	11.78
FL15012	FLAT BAR 150 X 12mm	14.13
FL15015	FLAT BAR 150 X 15mm	17.66
FL15020	FLAT BAR 150 X 20mm	23.55
FL15025	FLAT BAR 150 X 25mm	29.44
FL16010	FLAT BAR 160 X 10mm	12.56
FL18010	FLAT BAR 180 X 10mm	14.13
FL18012	FLAT BAR 180 X 12mm	16.96
FL18015	FLAT BAR 180 X 15mm	21.22
FL18020	FLAT BAR 180 X 20mm	28.26
FL18025	FLAT BAR 180 X 25mm	35.33
FL2006	FLAT BAR 200 X 6mm	9.42
FL2008	FLAT BAR 200 X 8mm	12.56
FL20010	FLAT BAR 200 X 10mm	15.69
FL20012	FLAT BAR 200 X 12mm	18.84
FL20015	FLAT BAR 200 X 15mm	23.55
FL20020	FLAT BAR 200 X 20mm	31.41
FL20025	FLAT BAR 200 X 25mm	39.25
FL20030	FLAT BAR 200 X 30mm	47.2



FLAT

PRODUCT CODE	DESCRIPTION	DENSITY
FL22010	FLAT BAR 220 X 10mm	17.27
FL22012	FLAT BAR 220 X 12mm	20.72
FL2506	FLAT BAR 250 X 6mm	11.78
FL2508	FLAT BAR 250 X 8mm	15.7
FL25010	FLAT BAR 250 X 10mm	19.625
FL25012	FLAT BAR 250 X 12mm	23.55
FL25015	FLAT BAR 250 X 15mm	29.44
FL25020	FLAT BAR 250 X 20mm	39.25
FL25025	FLAT BAR 250 X 25mm	49.06
FL3006	FLAT BAR 300 X 6mm	14.13
FL3008	FLAT BAR 300 X 8mm	18.84
FL30010	FLAT BAR 300 X 10mm	23.55
FL30012	FLAT BAR 300 X 12mm	28.26
FL30015	FLAT BAR 300 X 15mm	35.33
FL30020	FLAT BAR 300 X 20mm	47.15
FL30025	FLAT BAR 300 X 25mm	58.88
FL35010	FLAT BAR 350 X 10mm	27.48
FL35012	FLAT BAR 350 X 12mm	33.01
FL35015	FLAT BAR 350 X 15mm	41.25
FL35020	FLAT BAR 350 X 20	54.95



**D.KENNEDY
STEEL SUPPLIES LTD**



FLAT

PRODUCT CODE	DESCRIPTION	DENSITY
FL35025	FLAT BAT 350 X 25	68.69
FL40010	FLAT BAR 400 X 10mm	31.41
FL40012	FLAT BAR 400 X 12mm	37.68
FL40015	FLAT BAR 400 X 15mm	47.09
FL40020	FLAT BAR 400 X 20	62.81
FL40025	FLAT BAR 400 X 25	78.51
FL45010	FLAT BAR 450 X 10mm	35.325
FL45012	FLAT BAR 450 X 12mm	42.39
FL45015	FLAT BAR 450 X 15mm	52.99
FL45020	FLAT BAR 450 X 20	70.65
FL45025	FLAT BAR 450 X 25	88.31
FL50010	FLAT BAR 500 X 10	39.25
FL50012	FLAT BAR 500 X 12mm	47.1
FL50015	FLAT BAR 500 X 15mm	58.88
FL50020	FLAT BAR 500 X 20	78.5
FL50025	FLAT BAT 500 X 25	98.12



ROUND



PRODUCT CODE	DESCRIPTION	DENSITY
RD6	ROUND BAR 6mm	0.22
RD8	ROUND BAR 8mm	0.39
RD10	ROUND BAR 10mm	0.62
RD12	ROUND BAR 12mm	0.89
RD16	ROUND BAR 16mm	1.58
RD20	ROUND BAR 20mm	2.47
RD25	ROUND BAR 25mm	3.85
RD32	ROUND BAR 32mm	6.31
RD40	ROUND BAR 40mm	9.86
RD50	ROUND BAR 50mm	15.41
RD60	ROUND BAR 60mm	22
RD75	ROUND BAR 75mm	34.7



**D.KENNEDY
STEEL SUPPLIES LTD**



BMS ROUND

ROUND

PRODUCT CODE	DESCRIPTION	DENSITY
BMSRD6	BRIGHT MILD STEEL ROUND 6mm	0.22
BMSRD8	BRIGHT MILD STEEL ROUND 8mm	0.39
BMSRD10	BRIGHT MILD STEEL ROUND 10mm	0.62
BMSRD12	BRIGHT MILD STEEL ROUND 12mm	0.89
BMSRD16	BRIGHT MILD STEEL ROUND 16mm	1.57
BMSRD20	BRIGHT MILD STEEL ROUND 20mm	2.46
BMSRD25	BRIGHT MILD STEEL ROUND 25mm	3.85
BMSRD30	BRIGHT MILD STEEL ROUND 30mm	5.54
BMSRD31	BRIGHT MILD STEEL ROUND 31.75mm	6.23
BMSRD35	BRIGHT MILD STEEL ROUND 35mm	7.78
BMSRD38	BRIGHT MILD STEEL ROUND 38mm	8.91
BMSRD40	BRIGHT MILD STEEL ROUND 40mm	9.86
BMSRD50	BRIGHT MILD STEEL ROUND 50mm	15.41



**D.KENNEDY
STEEL SUPPLIES LTD**



SQUARE



PRODUCT CODE	DESCRIPTION	DENSITY
SQ1010	SQUARE BAR 10 X 10mm	0.79
SQ1212	SQUARE BAR 12 X 12mm	1.13
SQ1616	SQUARE BAR 16 X 16mm	2.01
SQ2020	SQUARE BAR 20 X 20mm	3.14
SQ2525	SQUARE BAR 25 X 25mm	4.91
SQ3030	SQUARE BAR 30 X 30mm	7.07
SQ4040	SQUARE BAR 40 X 40mm	12.6
SQ5050	SQUARE BAR 50 X 50mm	19.62
SQ100100	SQUARE BAR 100 X 100mm	78.5



SHEET

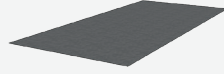

PRODUCT CODE	DESCRIPTION	DENSITY
CR SHEET		
CRSH630.9	CR SHEET 2000 X 1000 X 0.9mm	7.065
CRSH631.2	CR SHEET 2000 X 1000 X 1.2mm	9.42
CRSH631.5	CR SHEET 2000 X 1000 X 1.5mm	11.775
CRSH632	CR SHEET 2000 X 1000 X 2mm	15.7
CRSH632.5	CR SHEET 2000 X 1000 X 2.5mm	19.625
CRSH840.8	CR SHEET 2500 X 1250 X 0.8mm	6.28
CRSH840.9	CR SHEET 2500 X 1250 X 0.9mm	7.065
CRSH841	CR SHEET 2500 X 1250 X 1mm	7.85
CRSH841.2	CR SHEET 2500 X 1250 X 1.2mm	9.42
CRSH841.5	CR SHEET 2500 X 1250 X 1.5mm	11.775
CRSH842	CR SHEET 2500 X 1250 X 2mm	15.7
CRSH842.5	CR SHEET 2500 X 1250 X 2.5mm	19.625
CRSH843	CR SHEET 2500 X 1250 X 3mm	23.55
CRSH1051.2	CR SHEET 3000 X 1500 X 1.2mm	9.42



**D.KENNEDY
STEEL SUPPLIES LTD**



GALV SHEET

SHEET

PRODUCT CODE	DESCRIPTION	DENSITY
GSH840.6	GALV. SHEET 2500 X 1250 X 0.6mm	4.71
GSH840.8	GALV. SHEET 2500 X 1250 X 0.8mm	6.28
GSH840.9	GALV. SHEET 2500 X 1250 X 0.9mm	7.065
GSH841	GALV. SHEET 2500 X 1250 X 1mm	7.85
GSH841.2	GALV. SHEET 2500 X 1250 X 1.2mm	9.42
GSH841.5	GALV. SHEET 2500 X 1250 X 1.5mm	11.775
GSH842	GALV. SHEET 2500 X 1250 X 2mm	15.7
GSH842.5	GALV. SHEET 2500 X 1250 X 2.5mm	19.625
GSH843	GALV. SHEET 2500 X 1250 X 3mm	23.55
GSH1040.6	GALV. SHEET 3000 X 1250 X 0.6mm	4.71
GSH1041.2	GALV. SHEET 3000 X 1250 X 1.2mm	9.42
GSH1041.5	GALV. SHEET 3000 X 1250 X 1.5mm	11.775
GSH1042	GALV. SHEET 3000 X 1250 X 2mm	15.7
GSH1043	GALV. SHEET 3000 X 1250 X 3mm	23.55
GSH1050.8	GALV. SHEET 3000 X 1500 X 0.8mm	6.28
GSH1050.9	GALV. SHEET 3000 X 1500 X 0.9mm	7.065
GSH1051	GALV. SHEET 3000 X 1500 X 1mm	7.85
GSH1051.2	GALV. SHEET 3000 X 1500 X 1.2mm	9.42



**D.KENNEDY
STEEL SUPPLIES LTD**



GALV SHEET

SHEET

PRODUCT CODE	DESCRIPTION	DENSITY
GSH1051.5	GALV. SHEET 3000 X 1500 X 1.5mm	11.775
GSH1052	GALV. SHEET 3000 X 1500 X 2mm	15.7
GSH1053	GALV. SHEET 3000 X 1500 X 3mm	23.55



**D.KENNEDY
STEEL SUPPLIES LTD**



ZINTEC SHEET

SHEET

PRODUCT CODE	DESCRIPTION	DENSITY
ZINSH6315	ZINTEC SHEET 2000 X 1000 X 1.5mm	11.776
ZINSH8410	ZINTEC SHEET 2500 X 1250 X 1mm	7.85
ZINSH8412	ZINTEC SHEET 2500 X 1250 X 1.2mm	9.4176
ZINSH8415	ZINTEC SHEET 2500 X 1250 X 1.5mm	11.776
ZINSH842	ZINTEC SHEET 2500 X 1250 X 2mm	15.6992
ZINSH843	ZINTEC SHEET 2500 X 1250 X 3mm	23.55
ZINSH10515	ZINTEC SHEET 3000 X 1500 X 1.5mm	11.776



**D.KENNEDY
STEEL SUPPLIES LTD**



HR SHEET

SHEET

PRODUCT CODE	DESCRIPTION	DENSITY
SH6316	SHEET 2000 X 1000 X 1.6mm	12.56
SH632	SHEET 2000 X 1000 X 2mm	15.7
SH633	SHEET 2000 X 1000 X 3mm	23.55
SH8416	SHEET 2500 X 1250 X 1.6mm	12.56
SH842	SHEET 2500 X 1250 X 2mm	15.7
SH8425	SHEET 2500 X 1250 X 2.5mm	19.625
SH843	SHEET 2500 X 1250 X 3mm	23.55
SH1052	SHEET 3000 X 1500 X 2mm	15.7
SH10525	SHEET 3000 X 1500 X 2.5mm	19.625
SH1053	SHEET 3000 X 1500 X 3mm	23.55
SH1263	SHEET 3660 X 1830 X 3mm	23.55



PLATE

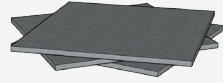

PRODUCT CODE	DESCRIPTION	DENSITY
PL634	PLATE 2000 X 1000 X 4mm	31.4
PL635	PLATE 2000 X 1000 X 5mm	39.25
PL636	PLATE 2000 X 1000 X 6mm	47.1
PL638	PLATE 2000 X 1000 X 8mm	62.8
PL6310	PLATE 2000 X 1000 X 10mm	78.5
PL844	PLATE 2500 X 1250 X 4mm	31.4
PL845	PLATE 2500 X 1250 X 5mm	39.25
PL846	PLATE 2500 X 1250 X 6mm	47.1
PL848	PLATE 2500 X 1250 X 8mm	62.8
PL8410	PLATE 2500 X 1250 X 10mm	78.5
PL8412	PLATE 2500 X 1250 X 12mm	94.2
PL8415	PLATE 2500 X 1250 X 15mm	117.75
PL8418	PLATE 2500 X 1250 X 18mm	141.3
PL8420	PLATE 2500 X 1250 X 20mm	157
PL8425	PLATE 2500 X 1250 X 25mm	196.25
PL8430	PLATE 2500 X 1250 X 30mm	235.5
PL8440	PLATE 2500 X 1250 X 40mm	314



PLATE

PRODUCT CODE	DESCRIPTION	DENSITY
PL8450	PLATE 2500 X 1250 X 50mm	392.5
PL1054	PLATE 3000 X 1500 X 4mm	31.4
PL1055	PLATE 3000 X 1500 X 5mm	39.25
PL1056	PLATE 3000 X 1500 X 6mm	47.1
PL1058	PLATE 3000 X 1500 X 8mm	62.8
PL10510	PLATE 3000 X 1500 X 10mm	78.5
PL10512	PLATE 3000 X 1500 X 12mm	94.2
PL10515	PLATE 3000 X 1500 X 15mm	117.75
PL10518	PLATE 3000 X 1500 X 18mm	141.3
PL10520	PLATE 3000 X 1500 X 20mm	157
PL10525	PLATE 3000 X 1500 X 25mm	196.25
PL10530	PLATE 3000 X 1500 X 30mm	235.5
PL10535	PLATE 3000 X 1500 X 35mm	274.75
PL10540	PLATE 3000 X 1500 X 40mm	314
PL10550	PLATE 3000 X 1500 X 50mm	392.5
PL1264	PLATE 3660 X 1830 X 4mm	31.4
PL1265	PLATE 3660 X 1830 X 5mm	39.25
PL1266	PLATE 3660 X 1830 X 6mm	47.1
PL1268	PLATE 3660 X 1830 X 8mm	62.8
PL424	PLATE 4000 X 2000 X 4mm	32



PLATE

PRODUCT CODE	DESCRIPTION	DENSITY
PL425	PLATE 4000 X 2000 X 5mm	39.25
PL426	PLATE 4000 X 2000 X 6mm	47.1
PL428	PLATE 4000 X 2000 X 8mm	62.8
PL4210	PLATE 4000 X 2000 X 10mm	78.5
PL4212	PLATE 4000 X 2000 X 12mm	94.2
PL4215	PLATE 4000 X 2000 X 15mm	117.75
PL4220	PLATE 4000 X 2000 X 20mm	157
PL4225	PLATE 4000 X 2000 X 25mm	196.25
PL4230	PLATE 4000 X 2000 X 30mm	235.5
PL5000250010	PLATE 5000 X 2500 X 10mm	78.5
PL5000250012	PLATE 5000 X 2500 X 12mm	94.2
PL5000250030	PLATE 5000 X 2500 X 30mm	235.5



CHEQUER PLATE



PRODUCT CODE	DESCRIPTION	DENSITY
ALUMINIUM CHEQUER PLATE		
ALXPL842	ALU. FLOOR PLATE 2500 X 1250 X 2mm	5.632
ALXPL843	ALU. FLOOR PLATE 2500 X 1250 X 3mm	8.32
ALXPL8445	ALU. FLOOR PLATE 2500 X 1250 X 4.5mm	12.64
ALXPL1052	ALU. FLOOR PLATE 3000 X 1500 X 2mm	25
ALXPL10153	ALU. FLOOR PLATE 3000 X 1500 X 3mm	38



**D.KENNEDY
STEEL SUPPLIES LTD**



MILD STEEL CHEQUER PLATE  **CHEQUER PLATE**

PRODUCT CODE	DESCRIPTION	DENSITY
XXXPL633	CHQ. FL PLATE 2000 X 100 X 3mm	26.5
XXXPL6345	CHQ. FL PLATE 2000 X 100 X 4.5mm	38
XXXPL636	CHQ. FL PLATE 2000 X 100 X 6mm	50
XXXPL843	CHQ. FL PLATE 2500 X 1250 X 3mm	26.83
XXXPL8445	CHQ. FL PLATE 2500 X 1250 X 4.5mm	38.59
XXXPL846	CHQ. FL PLATE 2500 X 1250 X 6mm	50.36
XXXPL848	CHQ. FL PLATE 2500 X 1250 8mm	65.6
XXXPL8410	CHQ. FL PLATE 2500 X 1250 X 10mm	81.28
XXXPL84125	CHQ. FL PLATE 2500 X 1250 X 12.5mm	103.04
XXXPL1053	CHQ. FL PLATE 3000 X 1500 X 3mm	26.83
XXXPL10545	CHQ. FL PLATE 3000 X 1500 X 4.5mm	38.59
XXXPL1056	CHQ. FL PLATE 3000 X 1500 X 6mm	50.36
XXXPL1058	CHQ. FL PLATE 3000 X 1500 X 8mm	66.04
XXXPL10510	CHQ. FL PLATE 3000 X 1500 X 10mm	81.73
XXXPL105125	CHQ. FL PLATE 3000 X 1500 X 12.5mm	101.34



HOLLOW

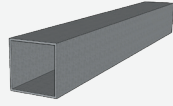

PRODUCT CODE	DESCRIPTION	DENSITY
SQUARE HOLLOW		
S20202	SHS 20 X 20 X 2mm	1.12
S25252	SHS 25 X 25 X 2mm	1.43
S25252.5	SHS 25 X 25 X 2.5mm	1.74
S25253	SHS 25 X 25 X 3mm	2.04
S30302	SHS 30 X 30 X 2mm	1.68
S30302.5	SHS 30 X 30 X 2.5mm	2.14
S30303	SHS 30 X 30 X 3mm	2.51
S40402	SHS 40 X 40 X 2mm	2.38
S40402.5	SHS 40 X 40 X 2.5mm	2.92
S40403	SHS 40 X 40 X 3mm	3.45
S40404	SHS 40 X 40 X 4mm	4.46
S40405	SHS 40 X 40 X 5mm	5.4
S50502	SHS 50 X 50 X 2mm	3
S50502.5	SHS 50 X 50 X 2.5mm	3.71
S50503	SHS 50 X 50 X 3mm	4.39
S50504	SHS 50 X 50 X 4mm	5.72



SQUARE HOLLOW SECTION 

HOLLOW

PRODUCT CODE	DESCRIPTION	DENSITY
S50505	SHS 50 X 50 X 5mm	7.03
S50506	SHS 50 X 50 X 6mm	8.49
S60603	SHS 60 X 60 X 3mm	5.34
S60604	SHS 60 X 60 X 4mm	6.97
S60605	SHS 60 X 60 X 5mm	8.54
S60606	SHS 60 X 60 X 6mm	9.45
S60608	SHS 60 X 60 X 8mm	11.3
S70703	SHS 70 X 70 X 3mm	6.28
S70703.5	SHS 70 X 70 X 3.5mm	7.26
S70704	SHS 70 X 70 X 4mm	8.23
S70705	SHS 70 X 70 X 5mm	10.1
S70706	SHS 70 X 70 X 6mm	12.5
S70708	SHS 70 X 70 X 8mm	15.3
S80803	SHS 80 X 80 X 3mm	7.22
S80803.5	SHS 80 X 80 X 3.5mm	8.36
S80804	SHS 80 X 80 X 4mm	9.11
S80805	SHS 80 X 80 X 5mm	11.7
S80806	SHS 80 X 80 X 6mm	13.91
S80808	SHS 80 X 80 X 8mm	17.8
S808010	SHS 80 X 80 X 10mm	21.833



**D.KENNEDY
STEEL SUPPLIES LTD**



SQUARE HOLLOW SECTION



HOLLOW

PRODUCT CODE	DESCRIPTION	DENSITY
S90903	SHS 90 X 90 X 3mm	8.16
S90903.6	SHS 90 X 90 X 3.6mm	9.72
S90904	SHS 90 X 90 X 4mm	10.7
S90905	SHS 90 X 90 X 5mm	13.3
S90906	SHS 90 X 90 X 6mm	15.1
S90908	SHS 90 X 90 X 8mm	20.8
S909010	SHS 90 X 90 X 10mm	25.53
S1001003	SHS 100 X 100 X 3mm	9.1
S1001004	SHS 100 X 100 X 4mm	12
S1001005	SHS 100 X 100 X 5mm	14.8
S1001006	SHS 100 X 100 X 6mm	17.6
S1001008	SHS 100 X 100 X 8mm	22.9
S10010010	SHS 100 X 100 X 10mm	27.9
S10010012.5	SHS 100 X 100 X 12.5mm	33.44
S1201205	SHS 120 X 120 X 5mm	18
S1201206	SHS 120 X 120 X 6mm	21.3
S1201208	SHS 120 X 120 X 8mm	27.9
S12012010	SHS 120 X 120 X 10mm	34.2
S120120125	SHS 120 X 120 X 12.5mm	41.6



SQUARE HOLLOW SECTION 

HOLLOW

PRODUCT CODE	DESCRIPTION	DENSITY
S1401408	SHS 140 X 140 X 8mm	32.9
S14014010	SHS 140 X 140 X 10mm	40.4
S140140125	SHS 140 X 140 X 12.5mm	49.5
S1501505	SHS 150 X 150 X 5mm	22.7
S1501506	SHS 150 X 150 X 6mm	27
S15015063	SHS 150 X 150 X 6.3mm	28.3
S1501508	SHS 150 X 150 X 8mm	35.4
S15015010	SHS 150 X 150 X 10mm	43.6
S150150125	SHS 150 X 150 X 12.5mm	53.4
S15015016	SHS 150 X 150 X 16mm	65.05
S1601608	SHS 160 X 160 X 8mm	38
S160160125	SHS 160 X 160 X 12.5mm	52.6
S1801806	SHS 180 X 180 X 6mm	32.1
S1801808	SHS 180 X 180 X 8mm	43
S18018010	SHS 180 X 180 X 10mm	50.7
S18018016	SHS 180 X 180 X 16mm	81.3
S2002005	SHS 200 X 200 X 5mm	30.5
S2002006	SHS 200 X 200 X 6mm	38.2
S2002008	SHS 200 X 200 X 8mm	48
S20020010	SHS 200 X 200 X 10mm	59.3



**D.KENNEDY
STEEL SUPPLIES LTD**



SQUARE HOLLOW SECTION



HOLLOW

PRODUCT CODE	DESCRIPTION	DENSITY
S200200125	SHS 200 X 200 X 12.5mm	73
S20020016	SHS 200 X 200 X 16mm	90.91
S220220125	SHS 220 X 220 X 12.5mm	80.1
S2502506	SHS 250 X 250 X 6mm	48.1
S2502508	SHS 250 X 250 X 8mm	60.5
S25025010	SHS 250 X 250 X 10mm	72.7
S250250125	SHS 250 X 250 X 12.5mm	91.91
S3003006	SHS 300 X 300 X 6mm	57.9
S3003008	SHS 300 X 300 X 8mm	73.1
S30030012.5	SHS 300 X 300 X 12.5mm	112



RECTANGULAR HOLLOW SECTION

HOLLOW

PRODUCT CODE	DESCRIPTION	DENSITY
R30202	RHS 30 X 20 X 2mm	1.36
R40202	RHS 40 X 20 X 2mm	1.75
R50252	RHS 50 X 25 X 2mm	2.15
R50252.5	RHS 50 X 25 X 2.5mm	2.72
R50253	RHS 50 X 25 X 3mm	3.07
R50302.5	RHS 50 X 30 X 2.5mm	2.92
R50303	RHS 50 X 30 X 3mm	3.45
R50304	RHS 50 X 30 X 4mm	4.46
R60303	RHS 60 X 30 X 3mm	3.77
R60403	RHS 60 X 40 X 3mm	4.39
R60404	RHS 60 X 40 X 4mm	5.72
R60405	RHS 60 X 40 X 5mm	6.97
R60406	RHS 60 X 40 X 6mm	8.3
R80402.5	RHS 80 X 40 X 2.5mm	4.47
R80403	RHS 80 X 40 X 3mm	5.34
R80404	RHS 80 X 40 X 4mm	6.97
R80405	RHS 80 X 40 X 5mm	8.54
R80502	RHS 80 X 50 X 2mm	3.88
R80502.5	RHS 80 X 50 X 2.5mm	4.78



**D.KENNEDY
STEEL SUPPLIES LTD**



RECTANGULAR HOLLOW SECTION

HOLLOW

PRODUCT CODE	DESCRIPTION	DENSITY
R80503	RHS 80 X 50 X 3mm	5.66
R90503	RHS 90 X 50 X 3mm	6.28
R100503	RHS 100 X 50 X 3mm	6.75
R100504	RHS 100 X 50 X 4mm	8.86
R100505	RHS 100 X 50 X 5mm	10.9
R100506	RHS 100 X 50 X 6mm	12.9
R100508	RHS 100 X 50 X 8mm	16.6
R1006035	RHS 100 X 60 X 3.5mm	8.36
R100605	RHS 100 X 60 X 5mm	11.7
R100606	RHS 100 X 60 X 6mm	13.9
R100806	RHS 100 X 80 X 6mm	15.8
R120403	RHS 120 X 40 X 3mm	6.62
R120603	RHS 120 X 60 X 3mm	8.16
R1206035	RHS 120 X 60 X 3.5mm	9.46
R1206036	RHS 120 X 60 X 3.6mm	9.72
R120605	RHS 120 X 60 X 5mm	13.3
R120606	RHS 120 X 60 X 6mm	15.7
R120608	RHS 120 X 60 X 8mm	20.4
R120805	RHS 120 X 80 X 5mm	14.8
R120806	RHS 120 X 80 X 6mm	17.6



RECTANGULAR HOLLOW SECTION

HOLLOW

PRODUCT CODE	DESCRIPTION	DENSITY
R120808	RHS 120 X 80 X 8mm	22.9
R1208010	RHS 120 X 80 X 10mm	27.9
R1501004	RHS 150 X 100 X 4mm	14.87
R1501005	RHS 150 X 100 X 5mm	18.7
R1501006	RHS 150 X 100 X 6mm	22.3
R1501008	RHS 150 X 100 X 8mm	29.1
R15010010	RHS 150 X 100 X 10mm	35.7
R15010012	RHS 150 X 100 X 12mm	43.6
R150100125	RHS 150 X 100 X 12.5mm	43.6
R160805	RHS 160 X 80 X 5mm	18
R160806	RHS 160 X 80 X 6mm	21.31
R160808	RHS 160 X 80 X 8mm	27.9
R1608010	RHS 160 X 80 X 10mm	34.2
R16080125	RHS 160 X 80 X 12.5mm	41.6
R1801005	RHS 180 X 100 X 5mm	21
R2001005	RHS 200 X 100 X 5mm	22.7
R2001006	RHS 200 X 100 X 6mm	27
R20010063	RHS 200 X 100 X 6.3mm	28.3
R2001008	RHS 200 X 100 X 8mm	35.4
R20010010	RHS 200 X 100 X 10mm	43.6



**D.KENNEDY
STEEL SUPPLIES LTD**



RECTANGULAR HOLLOW SECTION



HOLLOW

PRODUCT CODE	DESCRIPTION	DENSITY
R200100125	RHS 200 X 100 X 12.5mm	53.4
R2001208	RHS 200 X 120 X 8mm	36.5
R20012010	RHS 200 X 120 X 10mm	46.7
R2001506	RHS 200 X 150 X 6mm	33.2
R2001508	RHS 200 X 150 X 8mm	41.7
R20015010	RHS 200 X 150 X 10mm	52.1
R20015012.5	RHS 200 X 150 X 12.5mm	63.2
R2201205	RHS 220 X 120 X 5mm	2540%
R2501506	RHS 250 X 150 X 6mm	38.2
R2501508	RHS 250 X 150 X 8mm	48
R25015010	RHS 250 X 150 X 10mm	59.3
R250150125	RHS 250 X 150 X 12.5mm	68.3
R25015016	RHS 250 X 150 X 16mm	91.59
R3001008	RHS 300 X 100 X 8mm	46.5
R3001508	RHS 300 X 150 X 8mm	54.25
R30015010	RHS 300 X 150 X 10mm	64.81
R3002008	RHS 300 X 200 X 8mm	59.1
R30020010	RHS 300 X 200 X 10mm	75
R30020016	RHS 300 X 200 X 16mm	115.42



**D.KENNEDY
STEEL SUPPLIES LTD**



RECTANGULAR HOLLOW SECTION



HOLLOW

PRODUCT CODE	DESCRIPTION	DENSITY
R3501506	RHS 350 X 150 X 6mm	45.2
R35015010	RHS 350 X 150 X 10mm	72.7
R350150125	RHS 350 X 150 X 12.5mm	92.26
R4002006	RHS 400 X 200 X 6mm	54.7
R4002008	RHS 400 X 200 X 8mm	72.8
R40020010	RHS 400 X 200 X 10mm	90.23
R50030016	RHS 500 X 300 X 16mm	192



**D.KENNEDY
STEEL SUPPLIES LTD**



CIRCULAR HOLLOW SECTION

HOLLOW

PRODUCT CODE	DESCRIPTION	DENSITY
--------------	-------------	---------

SBCHS1615	SEMI BRIGHT CHS 16mm x 1.5mm	0.57
CHS2132	CHS 21.3 X 2mm	0.951
CHS21325	CHS 21.3 x 2.5mm	1.16
CHS2133	CHS 21.3 X 3mm	1.43
CHS2692	CHS 26.9 X 2mm	1.23
CHS26925	CHS 26.9 X 2.5mm	1.5
CHS2693	CHS 26.9 X 3.0mm	1.87
CHS33725	CHS 33.7 X 2.5mm	1.92
CHS3373	CHS 33.7 X 3mm	2.27
CHS4242	CHS 42.4 X 2mm	1.99
CHS42425	CHS 42.4 X 2.5mm	2.46
CHS4243	CHS 42.4 X 3mm	2.91
CHS4244	CHS 42.4 X 4mm	3.79
CHS48325	CHS 48.3 X 2.5mm	2.82
CHS48332	CHS 48.3 X 3mm	3.35
CHS4835	CHS 48.3 X 5mm	5.34
CHS48363	CHS 48.3 X 6.3mm	6.53
CHS4834	CHS 48.3 x 4mm	4.37
CHS6033	CHS 60.3 X 3mm	4.24



CIRCULAR HOLLOW SECTION

HOLLOW

PRODUCT CODE	DESCRIPTION	DENSITY
--------------	-------------	---------

CHS6034	CHS 60.3 X 4mm	5.65
CHS6035	CHS 60.3 X 5mm	6.82
CHS7613	CHS 76.1 X 3mm	5.41
CHS7614	CHS 76.1 X 4mm	7.11
CHS7615	CHS 76.1 X 5mm	8.77
CHS88925	CHS 88.9 X 2.5mm	5.3
CHS8893	CHS 88.9 X 3mm	6.36
CHS8894	CHS 88.9 X 4mm	8.38
CHS8895	CHS 88.9 X 5mm	10.3
CHS8896	CHS 88.9 X 6mm	12.36
CHS10122	CHS 101 X 2.2mm	5.4
CHS1013	CHS 101 X 3mm	7.29
CHS10136	CHS 101 X 3.6mm	8.7
CHS1014	CHS 101 X 4mm	9.65
CHS1015	CHS 101 X 5mm	11.91
CHS11433	CHS 114.3 X 3mm	8.23
CHS114335	CHS 114.3 X 3.5mm	9.56
CHS114336	CHS 114.3 X 3.6mm	9.83
CHS11434	CHS 114.3 X 4mm	10.9



**D.KENNEDY
STEEL SUPPLIES LTD**



CIRCULAR HOLLOW SECTION

HOLLOW

PRODUCT CODE	DESCRIPTION	DENSITY
--------------	-------------	---------

CHS11435	CHS 114.3 X 5mm	13.5
CHS11436	CHS 114.3 X 6.0mm	16.8
CHS1273	CHS 127 X 3mm	9.17
CHS1275	CHS 127 X 5mm	15.04
CHS12763	CHS 127 X 6.3mm	18.8
CHS13974	CHS 139.7 X 4mm	13.38
CHS13975	CHS 139.7 X 5mm	16.6
CHS13976	CHS 139.7 X 6mm	20.7
CHS13978	CHS 139.7 X 8mm	26
CHS139710	CHS 139.7 X 10mm	32
CHS16833	CHS 168.3 X 3mm	12.23
CHS16834	CHS 168.3 X 4mm	16.21
CHS16835	CHS 168.3 X 5mm	20.1
CHS16836	CHS 168.3 X 6mm	24
CHS16838	CHS 168.3 X 8mm	31.6
CHS168310	CHS 168.3 X 10mm	39
CHS1683125	CHS 168.3 X 12.5mm	48
CHS193710	CHS 193.7 X 10mm	45.3
CHS1937125	CHS 193.7 X 12.5mm	55.9
CHS19375	CHS 193.7 X 5mm	23.3



**D.KENNEDY
STEEL SUPPLIES LTD**



CIRCULAR HOLLOW SECTION

HOLLOW

PRODUCT CODE	DESCRIPTION	DENSITY
CHS193763	CHS 193.7 X 6.3mm	29.1
CHS19378	CHS 193.7 X 8mm	36.6
CHS219110	CHS 219.1 X 10mm	51.6
CHS2191125	CHS 219.1 X 12.5mm	63.7
CHS21915	CHS 219.1 X 5mm	26.4
CHS21916	CHS 219.1 X 6mm	31.53
CHS2448	CHS 244.5 X 8mm	46.7
CHS27304	CHS 273 X 4mm	26.53
CHS27305	CHS 273 X 5mm	33
CHS273125	CHS 273 X 12.5mm	80.03
CHS31748	CHS 31.75 X 4.88mm	3.23
CHS32396.3	CHS 323.9 x 6.3mm	49.3
CHS324127	CHS 324.0 X 12.7mm	96
CHS40646	CHS 406.4 x 6mm	59.2



GALV TUBE

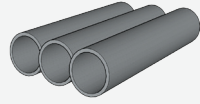

PRODUCT CODE	DESCRIPTION	DENSITY
GCHS26923	GALV CHS 26.9 X 2.3mm	1.5
GCHS26926	GALV CHS 26.9 X 2.6mm	1.56
GCHS33726	GALV CHS 33.7 X 2.6mm	1.99
GCHS33732	GALV CHS 33.7 X 3.2mm	2.44
GCHS4002	GALV CHS 40.0 X 2.0mm	1.87
GCHS42426	GALV CHS 42.4 X 2.5mm	2.46
GCHS42432	GALV CHS 42.4 X 3.25mm	3.14
GCHS48325	GALV CHS 48.3 X 2.5mm	2.82
GCHS48332	GALV CHS 48.3 X 3.2mm	3.61
GCHS60329	GALV CHS 60.3 X 2.9mm	4.11
GCHS60332	GALV CHS 60.3 X 3.2m	4.43
GCHS60336	GALV CHS 60.3 X 3.6m	5.03
GCHS7613	GALV CHS 76.1 X 3mm	5.41
GCHS76132	GALV CHS 76.1 X 3.2mm	5.75
GCHS76136	GALV CHS 76.1 X 3.6mm	6.44
GCHS88932	GALV CHS 88.9 X 3.2mm	6.76



**D.KENNEDY
STEEL SUPPLIES LTD**



GALV TUBE

PRODUCT CODE	DESCRIPTION	DENSITY
GCHS88936	GALV CHS 88.9 X 3.6mm	7.6
GCHS8894	GALV CHS 88.9 X 4mm	8.38
GCHS114345	GALV CHS 114.3 X 4.5mm	12.19
GCHSS337325	GALV CHS SCREWED & SOCKETED 33.7 X 3.25mm	2.51



MESH

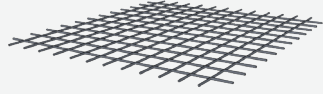

PRODUCT CODE	DESCRIPTION	DENSITY
GWMS841110	GALV. WELD MESH 8 X 4 X 1 X 1 X 10 G	4.0832
GWMS841112	GALV. WELD MESH 8 X 4 X 1 X 1 X 12 G	2.7456
GWMS842110	GALV. WELD MESH 8 X 4 X 2 X 1 X 10 G	3.1776
GWMS842210	GALV. WELD MESH 8 X 4 X 2 X 2 X 10 G	2.0736
GWMS84228	GALV. WELD MESH 8 X 4 X 2 X 2 X 8 G	3.52
GWMSH84338	GALV. WELD MESH 8 X 4 X 3 X 3 X 8 G	8.11
WMSH841110	WELD MESH 8 X 4 X 1 X 1 X 10 G	4.0832
WMSH841112	WELD MESH 8 X 4 X 1 X 1 X 12 G	2.7456
WMSH84118	WELD MESH 8 X 4 X 1 X 1 X 8 G	7.07
WMSH842110	WELD MESH 8 X 4 X 2 X 1 X 10 G	3.0784
WMSH842112	WELD MESH 8 X 4 X 2 X 1 X 12 G	2.0704
WMSH842210	WELD MESH 8 X 4 X 2 X 2 X 10 G	2.0736
WMSH84226	WELD MESH 8 X 4 X 2 X 2 X 6 G	5.0816
WMSH84228	WELD MESH 8 X 4 X 2 X 2 X 8 G	3.52
WMSH84338	WELD MESH 8 X 4 X 3 X 3 X 8 G	2.384



MESH

PRODUCT CODE	DESCRIPTION	DENSITY
WMSH84358	WELD MESH 8 X 4 X 3 X 1/2 X 8G	8.224
WMSH844112	WELD MESH 8 X 4 X 4 X 1 X 12 G	1.728
GWMSH843512	GALV WELD MESH 8 X 4 X 3 X 1/2 X 12G	3.58
MSH358	358 GALFAN SECURITY MESH 2.4M X 2.5M X 3" X 1/2" X 8G	8.666667



OPEN STEEL FLOORING

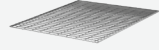

PRODUCT CODE	DESCRIPTION	DENSITY
OSFGPT253	OSF GALV Plain Top 25 X 3mm 6m X 1m 41-100	17.3
OSFGPT255	OSF GALV Plain Top 25 X 5mm 6m X 1m 41-100	26.97
OSFGPT303	OSF GALV Plain Top 30 X 3mm 6m x 1m 41-100	20.24
OSFGPT305	OSF GALV Plain Top 30 X 5mm 6m x 1m 41-100	31.88
OSFGPT403	OSF GALV Plain Top 40 X 3mm 6m x 1m 41-100	26.13
OSFGPT405	OSF GALV Plain Top 40 X 5mm 6mx1m 41-100	41.69
OSFGPT505	OSF GALV Plain Top 50 X 5mm 6m x 1m 41-100	51.5
OSFGST253	OSF GAL Serrated Top 25 X 3mm 6m X 1m 41-100	17.3
OSFGST255	OSF GAL Serrated Top 25 X 5mm 6m X 1m 41-100	27.334
OSFGST303	OSF GAL Serrated Top 30 X 3mm 6m x 1m 41-100	18.33



OPEN STEEL FLOORING

PRODUCT CODE	DESCRIPTION	DENSITY
OSFGST305	OSF GAL Serrated Top 30 X 5mm 6m x 1m 41-100	31.88
OSFGST30530100	OSF GAL Serrated Top 30 X 5mm 6m x 1m 30-100	25
OSFGST3605	OSF GAL Serrated Top 39 X 5mm 6m X 1m 41-100	32.5
OSFSCPT253	OSF Self Colour Plain Top 25 X 3mm 6m X 1m 41-100	17.3
OSFSCPT255	OSF Self Colour Plain Top 25 X 5mm 6mX1m 41-100	26.97
OSFSCPT303	OSF Self Colour Plain Top 30 X 3mm 6mx1m 41-100	20.24
OSFSCPT305	OSF Self Colour Plain Top 30 X 5mm 6mx1m 41-100	31.88
OSFSCPT30523100	OSF Self Colour Plain Top 30 X 5mm 6mx1m 23-100	45.83
OSFSCPT40330100	OSF Self Colour Plain Top 40 X 3mm 6mx1m 30-100	34.55
OSFSCPT405	OSF Self Colour Plain Top 40 X 5mm 6mx1m 41-100	41.69
OSFSCPT403	OSF Self Colour Plain Top 40 X 3mm 6mx1m 41-100	26.13
OSFSCPT505	OSF Self Colour Plain Top 50 X 5mm 6mx1m 41-100	51.5



OPEN STEEL FLOORING

PRODUCT CODE	DESCRIPTION	DENSITY
OSFSCST253	OSF Self Colour Serrated Top 25 X 3mm 6m X 1m 41-100	17.3
OSFSCST255	OSF Self Colour Serrated Top 25 X 5mm 6mx1m 41-100	26.97
OSFSCST305	OSF Self Colour Serrated Top 30 X 5mm 6mx1m 41-100	31.88
OSFSCST405	OSF Self Colour Serrated Top 40 X 5mm 6mx1m 41-100	41.69
STDG-0800	STAIRTREADS GALV 800 X 270mm 30 X 2; 34-38	26.852
STDG-0900	STAIRTREADS GALV 900 X 270mm 35 X 2; 34-38	27.16
STDG-1000	STAIRTREADS GALV 1000 X 270mm 30 X 3; 34-38	27.037
STDG-1100	STAIRTREADS GALV 1100 X 270mm 40 X 3; 34-38	39.731
STDG-1200	STAIRTREADS GALV 1200 X 270mm 40 X 3; 34-38	39.506
STDS-0800	STAIRTREADS Self Colour 800 X 270mm 30 X 3; 34-38	25.1
STDS-0900	STAIRTREADS Self Colour 900 X 270mm 35 X 2; 34-38	27.16
STDS-1000	STAIRTREADS Self Colour 1000 X 270mm 30 X 3; 34-38	25.1



GALVE COIL

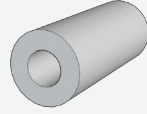

PRODUCT CODE	DESCRIPTION
GCOIL0.6	GALV COIL 1500 X 0.6mm
GCOIL0.7	GALV COIL 1500 X 0.7mm
GCOIL0.8	GALV COIL 1500 X 0.8mm
GCOIL1	GALV COIL 1500 X 1mm
GCOIL1.2	GALV COIL 1500 X 1.2mm



**D.KENNEDY
STEEL SUPPLIES LTD**



Q CLAMP



PRODUCT CODE	DESCRIPTION
WE032090	WELD ELBOW 42.4mm 90DEG
WE040090	WELD ELBOW 48.3mm 90DEG
25K40	TUBULAR HANDRAIL KNUCKLES FOR 40mm NB "D SIZE" FOR 48.3mm O/D TUBE (82mm O/D)
25KCB1	INTERNAL CORNER CONNECTION KICK PLATE CLAMP 42.3/48.3
25KCB3	STRAIGHT CONNECTOR 42.3/48.3
25KCB2	EXTERNAL CORNER CONNECTOR 42.3/48.3
QC104-1	104-1 26.9mm LONG TEE
QC116-1	116-1 26.9mm 3 WAY THROUGH
QC116-5	116-5 60.3mm 3 WAY THROUGH
QC116A-4	116A-4 48.3mm ADD ON 3 WAY THROUGH
QC119-1	119-1 26.9mm 2 SOCKET CROSS
QC119A-4	119A-4 48.3mm ADD ON 2 SOCKET CROSS
QC125H-2	125H-2 33.7mm SWIVEL ELBOW
QC128-1	128-1 26.9mm 3 WAY ELBOW



Q CLAMP

PRODUCT CODE	DESCRIPTION
QC129-2	129-2 33.7mm ADJUSTABLE TEE
QC125-1	125-1 26.9mm 90 deg ELBOW
QC130-2	130-2 33.7mm ADJUSTABLE CROSS
QC131-5	131-5 60.3mm WALL PLATE
QC132-1	132-1 26.9mm BASE PLATE
QC132-5	132-5 60.3mm BASE PLATE
QC133-1	133-1 26.9mm PLASTIC CAP
QC138-1	138-1 26.9mm GATE EYE
QC138-2	138-2 33.7mm GATE EYE
QC138-3	138-3 42.4mm GATE EYE
QC140-1	140-1 26mm GATE HINGE
QC140-2	140-2 33.7mm GATE HINGE
QC140-3	140-3 42.4mm GATE HINGE
QC143-1	143-1 26.9mm WALL MTD HR BRACKET
QC143-2	143-2 33.7mm WALL MTD HR BRACKET
QC144-2	144-2 33.7mm OSET SIDE PALM FXG
QC145-2	145-2 33.7mm NON STD OSET PALM
QC146-2	146-2 33.7mm FLUSH SIDE PALM FXG
QC147-2	147-2 33.7mm OFFSET SWIVEL TEE
QC147-3	147-3 42.4mm OFFSET SWIVEL TEE



Q CLAMP

PRODUCT CODE	DESCRIPTION
QC147-4	147-4 48.3mm OFFSET SWIVEL TEE
QC148-1	148-1 26.9mm SHORT SWIVEL TEE
QC167M-2	167M2 33.7mm DBL MALE SWVL COMBI
QC133-5	133-5 60.3mm PLASTIC CAP
QC134-2	134-2 33.7mm GROUND SOCKET
QC135-1	135-1 26.9mm RETRO CLAMP x TEE
QC135-2	135-2 33.7mm RETRO CLAMP x TEE
QC136-3	136-3 42.4mm ADD ON TEE
QC136-4	136-4 48.3mm ADD ON TEE
QC137-4	137-4 48.3mm CLAMP-ON CROSSOVER
QC158-3	158-3 42.4mm 4 WAY CROSS
QC158A-4	158A-4 48.3mm ADD ON 4 WAY CROSS
QC160-2	160-2 33.7mm RETRO FIT CLAMPON TEE
QC160-3	160-3 42.4mm RETRO FIT CLAMPON TEE
QC160-4	160-4 48.3mm RETRO FIT CLAMPON TEE
QC160-5	160-5 60.3mm RETRO FIT CLAMPON TEE
QC161-1	161-1 26.9mm OFFSET CROSSOVER
QC161-2	161-2 33.7mm OFFSET CROSSOVER
QC161-4/2	161-4/2 OFFSET CROSSOVER
QC165-1	165-1 26.9mm COMBI CROSSOVER



Q CLAMP

PRODUCT CODE	DESCRIPTION
QC165-2	165-2 33.7mm COMBI CROSSOVER
QC165-3	165-3 42.4mm COMBI CROSSOVER
QC165-4	165-4 48.3mm COMBI CROSSOVER
QC167-1	167-1 26.9mm DBL SWIVEL COMBI
QC167-2	167-2 33.7mm DBL SWIVEL COMBI
QC167M-3	167M3 42.4mm DBL MALE SWVL COMBI
QC167M-5	167M5 60.3mm DBL MALE SWVL COMBI
QC168-1	168-1 26.9mm 90deg CORNER SWIVEL
QC168-2	168-2 33.7mm 90deg CORNER SWIVEL
QC168-3	168-3 42.4mm 90deg CORNER SWIVEL
QC168M-2	168M-2 33.7mm MALE CORNER SWIVEL
QC168M-3	168M-3 42.4mm MALE CORNER SWIVEL
QC168M-4	168M-4 48.3mm MALE CORNER SWIVEL
QC169-1	169-1 26.9mm SWIVWL LOCATING FLG
QC169-2	169-2 33.7mm SWIVWL LOCATING FLG
QC169M	MALE SWIVEL LOCATING FLANGE
QC170-1	170-1 26.9mm SNGL MESH PANELCLIP
QC170-2	170-2 33.7mm SNGL MESH PANELCLIP
QC170-5	170-5 60.3mm SNGL MESH PANELCLIP
QC171-1	171-1 26.9mm DBL MESH PANEL CLIP



Q CLAMP

PRODUCT CODE	DESCRIPTION
QC171-2	171-2 33.7mm DBL MESH PANEL CLIP
QC173-1	173-1 26.9mm SINGLE SWIVEL
QC173-2	173-2 33.7mm SINGLE SWIVEL
QC173F-1	173F-1 26.9mm SNGL FEMALE SWVL
QC173F-2	173F-2 33.7mm SNGL FEMALE SWVL
QC173F-5	173F-5 60.3mm SNGL FEMALE SWVL
QC173M-1	173M-1 26.9mm SNGL MALE SWIVEL
QC173M-2	173M-2 33.7mm SNGL MALE SWIVEL
QC173M-3	173M-3 42.4mm SNGL MALE SWIVEL
QC173M-5	173M-5 60.3mm SNGL MALE SWIVEL
QC179-1	179-1 26.9mm LOCKING COLLAR
QC179-2	179-2 33.7mm LOCKING COLLAR
QC179-4	179-4 48.3mm LOCKING COLLAR
QC182-1	182-1 26.9mm HOOK
QC182-2	182-2 33.7mm HOOK
QC182-3	182-3 42.4mm HOOK
QC182-4	182-4 48.3mm HOOK
QC184-2	184-2 33.7mm GALVANISED PLUG
QC184-3	184-3 42.4mm GALVANISED PLUG
QC185-4	185-4 48.3mm EAVES FITTING



Q CLAMP

PRODUCT CODE	DESCRIPTION
QC191-4	191-4 48.3mm RIDGE FITTING
QC198-2	198-2 33.7mm DOUBLE SIDED FIXING BRACKET
QC198-3	198-3 42.4mm DOUBLE SIDED FIXING BRACKET
QC199-2	199-2 33.7mm ADJUSTABLE FIXING BRACKET
QC199-3	199-3 42.4mm ADJUSTABLE FIXING BRACKET
QC201-2	201-2 33.7mm SLOPE RANGE SHORT T
QC201-3	201-3 42.4mm SLOPE RANGE SHORT T
QC204-3	204-3 42.4mm SLOPE RANGE LONG T
QC219-2	219-2 33.7mm SLOPE RANGE CROSS
QC219-3	219-3 42.4mm SLOPE RANGE CROSS
QC224-2	224-2 33.7mm ADJUSTABLE ELBOW
QC232-3	232-3 42.4mm SLOPE RANGE BASE
QC246-2	246-2 33.7mm HORIZONTAL RAILING BASE
QC246-3	246-3 42.4mm HORIZONTAL RAILING BASE
QC247-3	QC247-3 42.4mm KICKBOARD ADAPTOR
QC255-4	255-4 48.3mm SLOPE LONG TEE 11-29 DEG
QC256-4	256-4 48.3mm SLOPE CROSS MIDDLE RAIL 11-29 DEG
QC161-5	161-5 60.3mm OFFSET CROSSOVER
QC171-5	171-5 60.3mm DBL MESH PANEL CLIP
QC179-3	179-3 42.4mm LOCKING COLLAR



Q CLAMP

PRODUCT CODE	DESCRIPTION
QC150-2	150-2 33.7mm INTERNAL TUBE CONN.
QC101-2	101-2 33.7mm SHORT TEE
QC161-4/3	161-4/3 OFFSET CROSSOVER
QC119-5	119-5 60.3mm 2 SOCKET CROSS
QC131-1	131-1 26.9mm WALL PLATE
QC133-2	133-2 33.7mm PLASTIC CAP
QC119-2	119-2 33.7mm 2 SOCKET CROSS
QC176-1	176-1 26.9mm 3 WAY OUTLET TEE
QC116-2	116-2 33.7mm 3 WAY THROUGH
QC148-2	148-2 33.7mm SHORT SWIVEL TEE
QC176-2	176-2 33.7mm 3 WAY OUTLET TEE
QC128-2	128-2 33.7mm 3 WAY ELBOW
QC176-4	176-4 48.3mm 3 WAY OUTLET TEE
QC225-2	225-2 33.7mm SLOPE RANGE ELBOW
QC173-5	173-5 60.3mm SINGLE SWIVEL
QC232-2	232-2 33.7mm SLOPE RANGE BASE
QC204-2	204-2 33.7mm SLOPE RANGE LONG T
QC104-5	104-5 50mm LONG TEE
QC128-5	128-5 60.3mm 3 WAY ELBOW
QC133-3	133-3 42.4mm PLASTIC CAP



Q CLAMP

PRODUCT CODE	DESCRIPTION
QC149-5	149-5 60.3mm EXTERNAL TUBE CONN.
QC149-2	149-2 33.7mm EXTERNAL TUBE CONN.
QC168-4	168-4 48.3mm 90deg CORNER SWIVEL
QC170-3	170-3 42.4mm SNGL MESH PANELCLIP
QC171-3	171-3 42.4mm DBL MESH PANEL CLIP
QC253-4	253-4 48.3mm SLOPE SHORT TEE 11-29 DEG
QC225-3	225-3 42.4mm SLOPE RANGE ELBOW
QC134-4	134-4 48.3mm GROUND SOCKET
QC125H-3	125H-3 42.4mm SWIVEL ELBOW
QC144-3	144-3 42.4mm OSET SIDE PALM FXG
QC132-2	132-2 33.7mm BASE PLATE
QC149-1	149-1 26.9mm EXTERNAL TUBE CONN.
QC148-3	148-3 42.4mm SHORT SWIVEL TEE
QC130-3	130-3 42.4mm ADJUSTABLE CROSS
QC146-3	146-3 42.4mm FLUSH SIDE PALM FXG
QC251-3	251-3 42.4mm ANGLED BASE FLANGE 30-45 DEG
QC129-3	129-3 42.4mm ADJUSTABLE TEE
QC173F-3	173F-3 42.4mm SNGL FEMALE SWVL
QC161-3	161-3 42.4mm OFFSET CROSSOVER
QC167-3	167-3 42.4mm DBL SWIVEL COMBI



Q CLAMP

PRODUCT CODE	DESCRIPTION
QC140-4	140-4 48.3mm GATE HINGE
QC199-4	199-4 48.3mm ADJUSTABLE FIXING BRACKET
QC169-3	169-3 42.4mm SWIVWL LOCATING FLG
QC176-3	176-3 42.4mm 3 WAY OUTLET TEE
QC135-4	135-4 48.3mm RETRO CLAMP x TEE
QC198-4	198-4 48.3mm DOUBLE SIDED FIXING BRACKET
QC104-2	104-2 33.7mm LONG TEE
QC131-2	131-2 33.7mm WALL PLATE
QC175-4	175-4 48.3mm SWIVEL ELBOW
QC225-4	225-4 48.3mm SLOPE RANGE ELBOW
QC224-3	224-3 42.4mm ADJUSTABLE ELBOW
QC301-4	GRUBSCREWS (3/8") To Suit 48.3 O/D Tube
QC134-3	134-3 42.4mm GROUND SOCKET
QC129-4	129-4 48.3mm ADJUSTABLE TEE
QC143-3	143-3 42.4mm WALL MTD HR BRACKET
QC173F-4	173F-4 48.3mm SNGL FEMALE SWWL
QC173-3	173-3 42.4mm SINGLE SWIVEL
QC184-4	184-4 48.3mm GALVANISED PLUG
QC246-4	246-4 48.3mm HORIZONTAL RAILING BASE
QC135-3	135-3 42.4mm RETRO CLAMP x TEE



Q CLAMP

PRODUCT CODE	DESCRIPTION
QC149-3	149-3 42.4mm EXTERNAL TUBE CONN.
QC149-4	149-4 48.3mm EXTERNAL TUBE CONN.
QC171-4	171-4 48.3mm DBL MESH PANEL CLIP
QC131-3	131-3 42.4mm WALL PLATE
QC170-4	170-4 48.3mm SNGL MESH PANELCLIP
QC132-3	132-3 42.4mm BASE PLATE
QC146-4	146-4 48.3mm FLUSH SIDE PALM FXG
QC145-3	145-3 42.4mm NON STD OSET PALM
QC116-3	116-3 42.4mm 3 WAY THROUGH
QC101-3	101-3 42.4mm SHORT TEE
QC144-4	144-4 48.3mm OSET SIDE PALM FXG
QC130-4	130-4 48.3mm ADJUSTABLE CROSS
QC138-4	138-4 48.3mm GATE EYE
QC148-4	148-4 48.3mm SHORT SWIVEL TEE
QC167-4	167-4 48.3mm DBL SWIVEL COMBI
QC169-4	169-4 48.3mm SWIVWL LOCATING FLG
QC173-4	173-4 48.3mm SINGLE SWIVEL
QC143-4	143-4 48.3mm WALL MTD HR BRACKET
QC104-3	104-3 42.4mm LONG TEE
QC150-3	150-3 42.4mm INTERNAL TUBE CONN.



Q CLAMP

PRODUCT CODE	DESCRIPTION
QC145-4	145-4 48.3mm NON STD OSET PALM
QC247-4	QC247-4 48.3mm KICKBOARD ADAPTOR
QC125H-4	125H-4 48.3mm SWIVEL ELBOW
QC167M-4	167M4 48.3mm DBL MALE SWVL COMBI
QC128-4	128-4 48.3mm 3 WAY ELBOW
QC232-4	232-4 48.3mm SLOPE RANGE BASE
QC219-4	219-4 48.3mm SLOPE RANGE CROSS
QC104-4	104-4 48.3mm LONG TEE
QC133-4	133-4 48.3mm PLASTIC CAP
QC131-4	131-4 48.3mm WALL PLATE
QC132-4	132-4 48.3mm BASE PLATE
QC125-2	125-2 33.7mm 90 deg ELBOW
QC158-4	158-4 48.3mm 4 WAY CROSS
QC173M-4	173M-4 48.3mm SNGL MALE SWIVEL
QC119-4	119-4 48.3mm 2 SOCKET CROSS
QC204-4	204-4 48.3mm SLOPE RANGE LONG T
QC161-4	161-4 48.3mm OFFSET CROSSOVER
QC101-4	101-4 48.3mm SHORT TEE
QC201-4	201-4 48.3mm SLOPE RANGE SHORT T



Q CLAMP

PRODUCT CODE	DESCRIPTION
QC123-4	QC123-4 ACCUTE ANGLE ELBOW
QC128-3	128-3 42.4mm 3 WAY ELBOW
QC119-3	119-3 42.4mm 2 SOCKET CROSS
QC224-4	224-4 48.3mm ADJUSTABLE ELBOW
QC125-3	125-3 42.4mm 90 deg ELBOW
QC150-4	150-4 48.3mm INTERNAL TUBE CONN.
QC125-4	125-4 48.3mm 90 deg ELBOW
QC116-4	116-4 48.3mm 3 WAY THROUGH
QC158-1	158-1 26.9mm 4 WAY CROSS
QC158-2	158-2 33.7mm 4 WAY CROSS
QC252-4	252-4 48.3mm SLOPE BASE FLANGE 11-29 DEG
QC125-5	125-5 60.3mm 90 deg ELBOW
QC101-5	101-5 60.3mm SHORT TEE